

Date: Tues Sep 10, 2024 **Author:** Stephanie Charlie **Project:** Kipp Ave, Chilliwack
Job Start Date: TBD **Job End Date:** TBD **Company:** Mann Group
Contact: Jason Thorne (604)793-6363 **Drawing #:** 2 **Revision #:** 2

Comments:

- Traffic Control Plan Set Up to conform with TMM 2020
- Reference MoTI Figure 7.8: Lane Closure with TCPs – Single Lane Alternating – Short and Long Duration with modifications
- Traffic Control Person (TCP) to be positioned on shoulder or curb adjacent to the traffic being controlled
- TCPs will single lane alternate traffic
- No Parking Signs will go in the red area
- No Parking Signs will include: Dates, Times, Company Name and Contact Number
- No Parking signs to be installed 72 hours prior in advance
- Sidewalk along the property are already permanently closed
- Sidewalk closed cross here signs will be placed at the crosswalks
- Road will be cleaned of all work equipment and road signs by the end of each working day and road will go back to normal

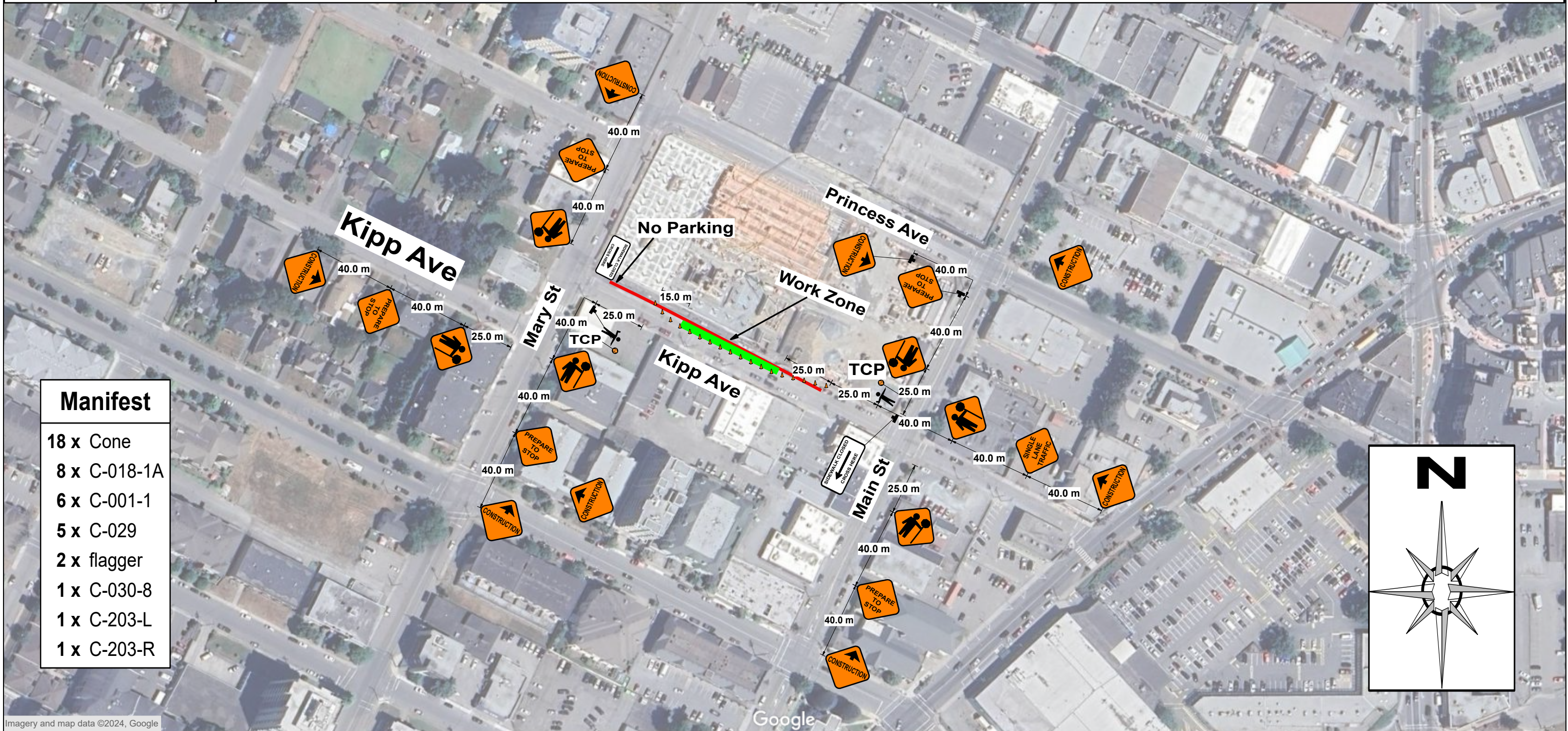

Manifest
18 x Cone
8 x C-018-1A
6 x C-001-1
5 x C-029
2 x flagger
1 x C-030-8
1 x C-203-L
1 x C-203-R

